

Courses up the Creek

N 58 E 26 1/2
N 11 1/2 E 55 to Elm
8 1/2 per.

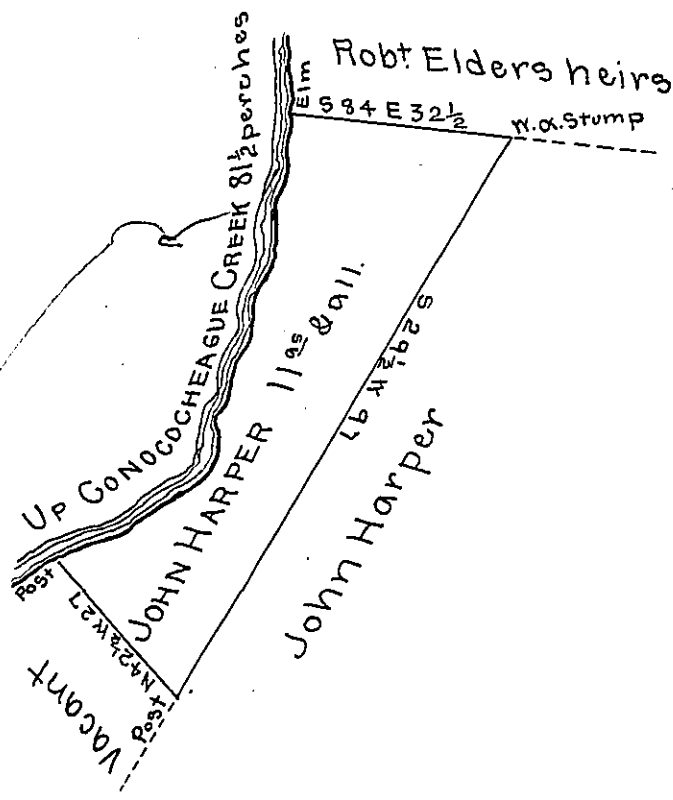

A Draught of a Peice of Land Situate in Metal Township Franklin County Containing Eleven acres and the usual allowance of six p. cent for Roads &c. Surveyed June 12-1812 in persuance of a Warrant granted John Harper Dated June 29th 1811.

To Andrew Porter Esq^r
Surveyor General of Penn^a

Thomas Poe D.S.

IN TESTIMONY that the above is a copy of the original remaining on file in the Department of Internal Affairs of Pennsylvania, made conformably to an Act of Assembly approved the 16th day of February, 1833, I have hereunto set my Hand and caused the Seal of said Department to be affixed at Harrisburg, this twenty-seventh day of April 1905

Isaac N. Brown
Secretary of Internal Affairs.